



# Welcome to all of our Year 8 Parents and Carers

## OBHS Values

Quality Fairness Integrity Compassion Mutual Respect Tolerance

## OBHS Ambitions

**Enable** all students to learn, grow and develop.

**Equip** students for the next stage of their lives with the skills, qualities and qualifications they need to be successful.

**Provide** a safe environment where everyone can flourish.

**Foster** and value relationships with our parents, carers and our community to strengthen a sense of belonging.

*Be the best we can be*





# Who's Who?



**Mr Stephen  
Cowan**

**Year 8  
Progress  
Leader**

**Ms Theresa  
Picksley**

**Key Stage 3  
Pastoral  
Manager**



## Year 8 Progress and Pastoral Team





**Mr Fell**  
**Headteacher**

**Mr Dwight**  
**Deputy**  
**Headteacher**  
Behaviour, Attendance,  
Safeguarding



**Ms Cooper**  
**Assistant**  
**Headteacher**  
**Curriculum**  
**Leader for English**

**Mrs Morgan**  
**Deputy**  
**Headteacher**  
Teaching and Learning,  
The Curriculum



# The Senior Leadership Team





The names of the Houses have now been changed. The names were chosen last year by our students to reflect people that they find inspiring role models.

Blue	Sharman
Green	Attenborough
Purple	Malala
Red	Rashford
Yellow	Turing







## Break Time

Students are permitted to socialise in any of the social time areas during breaktime.

Students must purchase their food from the food area assigned to their year group.

**Year 8 – The Snack Shed (Hard Courts)**

## Lunchtime

Students are only permitted to socialise in their allocated social space at lunchtime: ILT sessions are happening around the school site at the same time.

Students will purchase all food from the station in their social area, and use the toilets assigned to their area too.

**Year 8 Red**

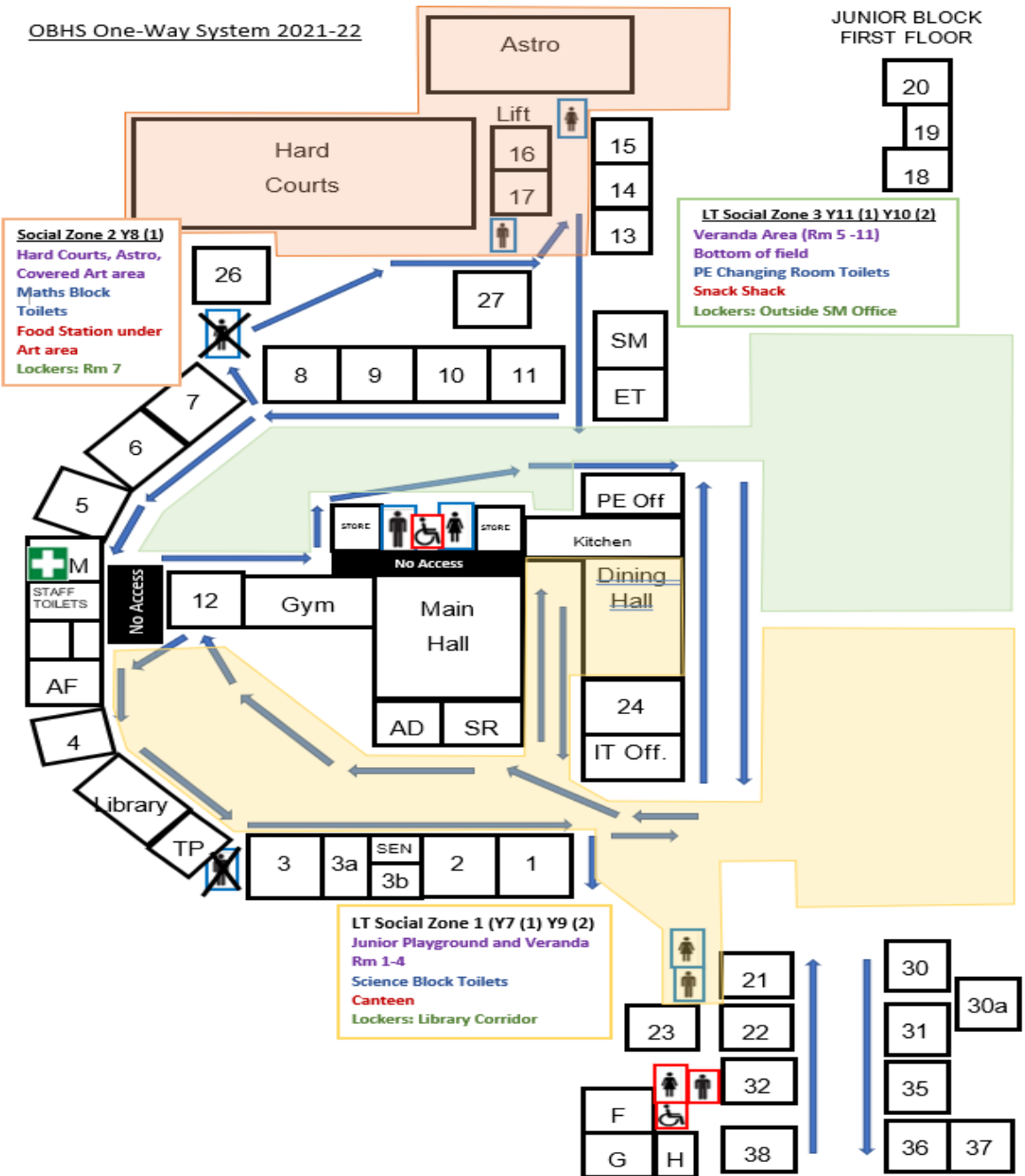



# The OBHS Habits of Learning





# Resilience

The **determination to recover** from and **cope with difficulties** or problems.

## A resilient learner:

- sticks with difficult situations – not seeing barriers as a reason to give up;
- tolerates (is ok with) uncertainty;
- dares to be different;
- Works hard to maintain effective relationships with others;
- Reflects on, and learns from, the mistakes they make.



*Resilience*



*Resilience*



# Creativity

Using **skill and imagination** when completing a task; to look at things or present things in a **different and original way**.

## A creative learner:

- inquires and asks questions;
- wonders, explores, investigates;
- experiments and plays with possibilities;
- uses their intuition;
- makes connections;



*Creativity  
Inquisition*



*Creativity  
Inquisition*





# Independence

Taking **responsibility** for learning, being **confident and capable of making choices** with the intended outcome being that they **achieve a goal**.

An independent learner:

- is self-directed,
- is well-organised,
- inquires and asks questions;
- reflects critically – evaluates and improves;
- understands what kind of learner they are and how they learn best;
- develops strategies to support their own learning;
- is a life-long learner.



*Independence*



*Independence*



# Collaboration

Working **effectively** with others so that **learning is enhanced** by these opportunities.

- A collaborative learner:
- will work with others to search for and develop understanding or a solution;
- is kind, considerate and supportive of others;
- is tolerant: values, accepts and respects all other members of the OBHS community;
- is an individual who works to be a valuable member of the OBHS community.



*Collaboration*



*Collaboration*



# Ambition

Having a **strong desire** and **self-belief** to achieve a **goal**.

- An ambitious learner:
- will set themselves challenging targets and actively work towards achieving them;
- will seek out opportunities (both in and outside school) to further develop and better themselves;
- will identify possible barriers in order to look for solutions, not feel restricted by them;
- will take pride in themselves, identify their strengths and celebrate these.



*Ambition*



*Ambition*



# OBHS Habits



Students will be awarded Habits cards to reward Ambition, Creativity, Collaboration, Independence and Resilience in lessons and during the school day.

They then post these into the Habits boxes which are found in Student Reception. Firstly, we will complete a prize draw for each Habit at the end of each half term where cards will be drawn from each box and these students will win a prize. In addition, the boxes will be emptied and Habits cards counted up each half term. Their form tutor will be able to access your total once this has been completed.

Students will then be able to exchange your Habits cards for a series of rewards. Progress Leaders will update them as to what is available in the Habits exchange.

We also award certificates and badges for their blazers when they reach 10 Habits cards in a Habit (10 in Creativity would earn their Creativity colour and certificate). These certificates can be added to their Record of Achievement.



Once they have exchanged your Habits points, they cannot exchange those vouchers on rewards again, but they are not removed from a student's running total which will earn you your award (your certificate and badge).



## The OBHS Award

In addition to receiving Habits cards to reward a child demonstrating Ambition, Creativity, Collaboration, Independence and Resilience in lessons, they will also be awarded Habits points on Go4Schools to reward them for consistently demonstrating the Habits in lessons and during the school day over time. These can be awarded by any member of staff.

Points	Independence	Resilience	Collaboration	Ambition	Creativity
2	Outstanding Piece of Work/ participation in a lesson.	Evidence of academic progress. To be awarded no more frequently than once a half term.	Regular attendance to enrichment activity. To be awarded termly.	Exceeding a Target Grade in a Subject. Evidence of this will be seen in data entered on to G4S.	Actively involved in Creative Arts (concerts, competitions, festivals etc.). To be entered once for each concert/ competition/ festival.
	Evidence over time of effective organisation and self-direction		Is regularly kind, considerate, helpful, tolerant of others regardless of differences.	Shows a commitment to setting challenging personal targets (and working actively to achieve them).	Regular evidence of approaching tasks creatively.
	Star of the Week.	Star of the Week.	Star of the Week.	Star of the Week	Star of the Week.
	Commitment to an enrichment activity. To be awarded on completion of the award/ certificate.	100% attendance for half a term. Awarded by HoY at the end of each half term.	Actively involved in whole school community: litter picking, ambassador, student panel, inter-house, sports day.	Takes pride in themselves as a student at OBHS. Evident in the presentation of themselves and the presentation and quality of their work over time.	Regular evidence of the student wondering, investigating and inquiring: asking thoughtful questions listening actively.
		Evidence over time of sticking with difficult situations, and not seeing barriers as a reason to give up.	Is regularly a valuable member of a group during collaborative work.		
Evidence over time of engagement with feedback leading to reflection and high quality improvement.	Shows regular evidence that they can reflect and learn from mistakes they have made.			Working actively and creatively to solve a problem (raising money for charity, being a part of a student focus group)	
	<b>Independence</b>	<b>Resilience</b>	<b>Collaboration</b>	<b>Ambition</b>	<b>Creativity</b>
4	Additional role within school: prefect, form captain, school council, student librarian. To be awarded once every term for the duration of the role.	Significant contribution to a school team (involving additional time commitment etc.). To be awarded once every term for the duration of the role.	Student Mentoring (including literacy and numeracy). To be awarded once every term for the duration of the role.	Achievement Awards: For example, Anti-Bullying Ambassador. To be awarded once on the completion of the award.	Significant involvement in the annual production. To be awarded once a year (due to the annual nature of the production).





## The OBHS Award

The OBHS Habits means that we are able to reward students for behaviours in and outside the classroom which show them as an excellent learner, role model and ambassador.

It is important to note that repeated and regular negative behaviours will have an impact on a student's points total: forgetting a piece of homework once, for example, will be recorded with a Negative (C1) comment on G4S. If, however, you regularly fail to prepare for a lesson and forget homework, a student will receive a C2 negative comment which carries with it a score of -1. This means that a point will be deducted from their overall point score.

**Each half term, totals will be calculated, and anybody meeting the totals below will be awarded with their OBHS award in that colour.**

Bronze	20 Points
Silver	60 Points
Gold	150 Points
Platinum	300 Points







**OLD BUCKENHAM**  
HIGH SCHOOL

*Achieving excellence together*

**RECORD OF ACHIEVEMENT**

# Celebrating Success

**Here at OBHS, all students are given Records of Achievement.**

*These folders are designed to display successes and track progress.*

*They will be invaluable when it comes to applying for sixth forms and colleges, apprenticeships, jobs...whatever the next step may be.*

# Here are some of the certificates and awards a student can earn here at OBHS

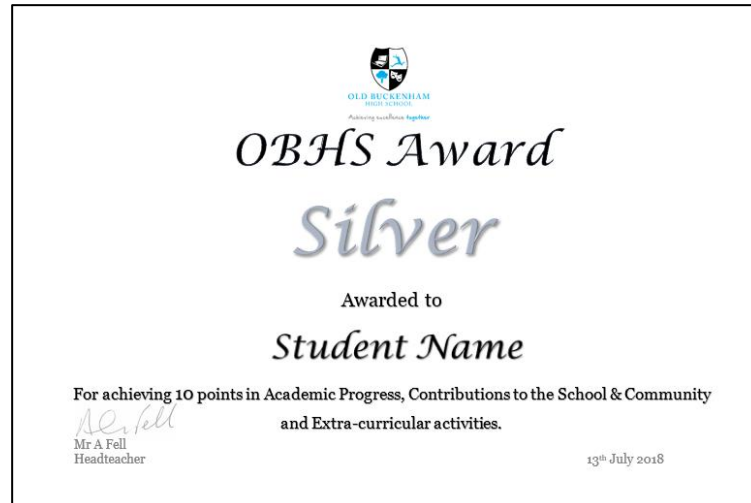

The OBHS Award

## Progress and Achievement Awards on Awards Evening



...it doesn't stop there!



Colours in Music and Drama

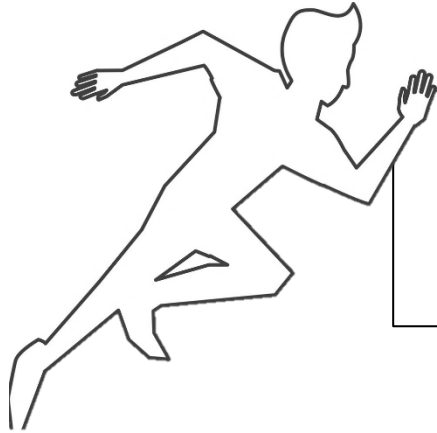

Or their sports colours for being a regular member of one of the teams

Students might earn awards and certificates outside school which they would like to keep copies of in their Record of Achievement.

# The Curriculum Beyond Year 8

Students will identify 2 of Graphic Design, Product Design and Food & Nutrition as their preferences to study in Year 9. All students will be allocated a minimum of 1 of their preferences, where possible, students will be allocated both. Students will undertake one of their subjects from September to February and the other February to July. This will be organised in the summer term.

Students will indicate their preferred language between French and German towards the end of Y8. Where possible, students will be placed into a class which means that they continue to study their preferred language. Students are unable to continue to study both languages beyond Year 8. The language allocated for Y9 will be the one they continue with at GCSE.

During Year 9, students will be guided through the Options process whereby they are allocated their subjects for KS4 study.



# Extra Curricular Activities

There are many exciting opportunities on offer.

A full range of after school sports clubs and teams (Hockey, football and netball), including the Running for Wellbeing club on a Thursday.

Working with the anti-bullying ambassadors.

Allotment Club (Mondays after School).

Lunchtime Clubs including Homework Club and Creative Writing Club

Choir for all Year groups (on a Monday lunchtime)

Involvement in the School Production, 'Back to the 80s!'



# High Standards Getting it Right







# Using Go4Schools

It is the system we use to log behaviour (positive and negative), register attendance, and record students' Attitudes to Learning, performance in subjects, completion of homework etc.

## **What to expect and look out for**

- At the end of every half term, we will report on your child's Attitude to Learning and Work Produced.
- At the end of each term, your child's assessment scores will be uploaded for each of the subjects they have been undertaking.
- Positive and negative behaviour points will be uploaded throughout the term.



## OBHS - Golden rules

1. Students need to keep a respectful distance at all times
2. Enter the room quietly, stand before being asked to be seated
3. Place equipment on desk
4. Remain quiet during the register
5. Listen to the teacher and other students without interruption or shouting out
6. Mobile phones turned off and put away, used only with permission of an adult
7. Follow instructions of all adults
8. No eating in lessons
9. Complete required tasks and activities
10. Pack away and stand behind desks at the direction of the teacher





## Behaviour Protocols

1. Student to be removed after one warning or a timeout. Removed students are sent to Room 4 where they will log in to EdClass and complete work in the subject.
2. A student who is removed, automatically receives three lunch time detentions.
3. If a student fails to follow instructions with regards to correct uniform, mobile phones, or behaviour during social time, students will be removed from their social time in lunchtime detention(s) .
4. If a student is removed from 2 lessons in a day, they are internally excluded for the remainder of that day.





# Negative Behaviour

## understanding what it means

In line with our school behaviour policy, students' negative behaviours will fall into the following four classifications

*C1-Minor Incidents inside/outside the classroom*

*C2-Persistent incidents, or incidents of medium severity (-1)*

*C3-Serious Incidents (-1)*

*C4-Very Serious Incidents (-1)*



*Be the best we can be*

# Attendance

## MAXIMISE EVERY OPPORTUNITY

Attendance – if a student isn't here, they can't make the most of all of the learning opportunities in and around the classroom !

Active Learners – actively engage in all learning opportunities. Just sitting in the room isn't enough.

It's important that they give themselves the best chance of being their best.

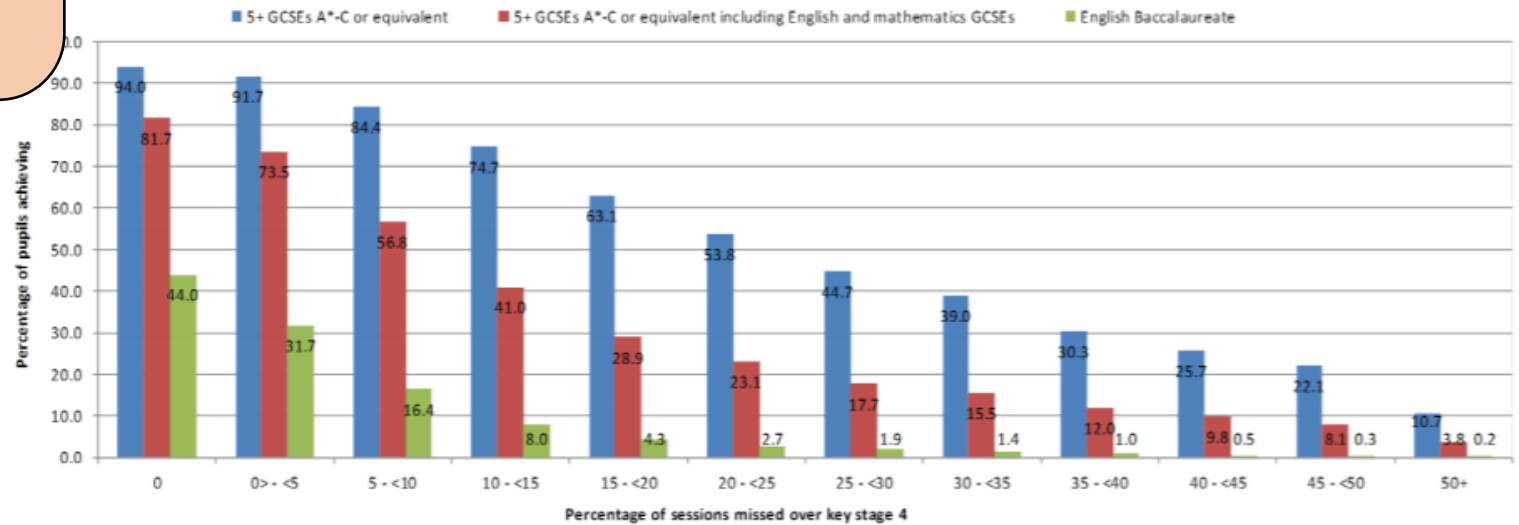

Number of pupils at end of key stage 4 in each corresponding absence percentage point band

14,990    298,220    130,850    48,845    18,185    8,590    4,870    2,805    1,920    1,280    865    2,515



Be the best we can be

# Uniform

The School Uniform Policy is available on the website.



<b>Jewellery</b>	<b>Watch</b> <b>One stud per ear lobe</b> <b>No rings</b>	<ul style="list-style-type: none"><li>•No facial piercings (including tongues)</li><li>•No body artistry</li><li>•No jewellery in PE</li></ul>
------------------	---	--







# The Library

The library is open to all students at lunch and break as a quiet study space for reading and homework.

Students from all year groups may borrow a book from the library for 2 weeks, before they must return or renew it.

Students in Year 7, 8 and 9 can quiz to earn points and rewards from their reading by logging in to Accelerated Reader and entering the book quiz code from the label on the front of the book.

